

INSTALLATION GUIDE

Roof assembly sequence

The panels should be installed from the eaves up to the ridge, and they can be laid from either right to left or left to right as required. In this example, the panels are shown laid from right to left. Install the panels in the sequence indicated: 1, 2, and 3.

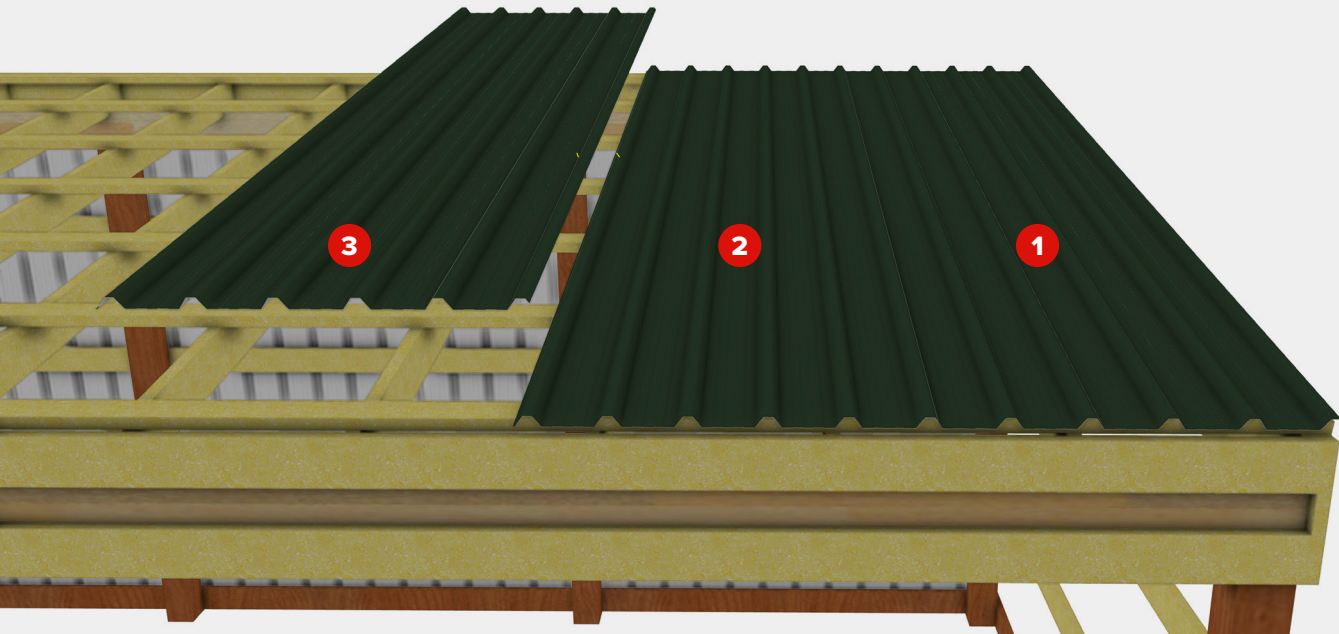

Important safety information

Our metal profiled roof and cladding sheets should be handled by two people and it is important for installers to wear safety equipment such as gloves to prevent any accidental injuries.

Fixings guide

When installing the sheets from right to left, begin by securing fixings at position (1). Once the panel is stable, continue fixing in the middle of the centre swage point (2, 3, 4 and 5). After securing the first sheet, position the next sheet along the sidelap side and fix it as shown at position (6). 22mm Stitcher fixings (ST) should be fixed on the sidelap corrugation ever max 400mm centres.

Continue placing fixings at each centre swage point until all sheets are fully installed.

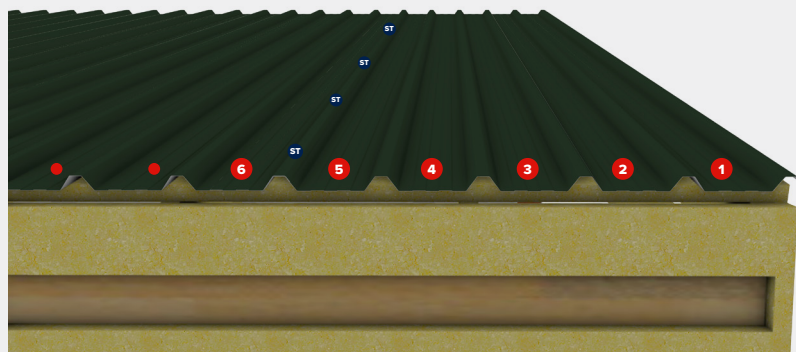

Our recommended fixings

Type	Purlin material	Recommended fixing
Roof	Timber	Ø 6.5 x 32mm
	Light Section	Ø 6.5 x 70mm
	Heavy Section	Ø 6.5 x 67mm
Cladding (wall)	Timber	Ø 6.5 x 75mm
	Light Section	Ø 6.5 x 50mm
	Heavy Section	Ø 6.5 x 38mm

Lift the Sheet: Pick up the sheet that needs to be installed and lift it into position (marked as step 1 in the visual guide).

Slot the Sidelap Corrugation: With the sheet lifted, align the sidelap corrugation beneath the adjoining sheet (step 2).

Lower the Sheet: Carefully place the sheet back down onto the purlin, ensuring it aligns correctly with the underlying support structure (step 3).

Secure the Sheet: Once satisfied with the alignment, fix the panel in place by securing it into each corrugation as shown (step 4).

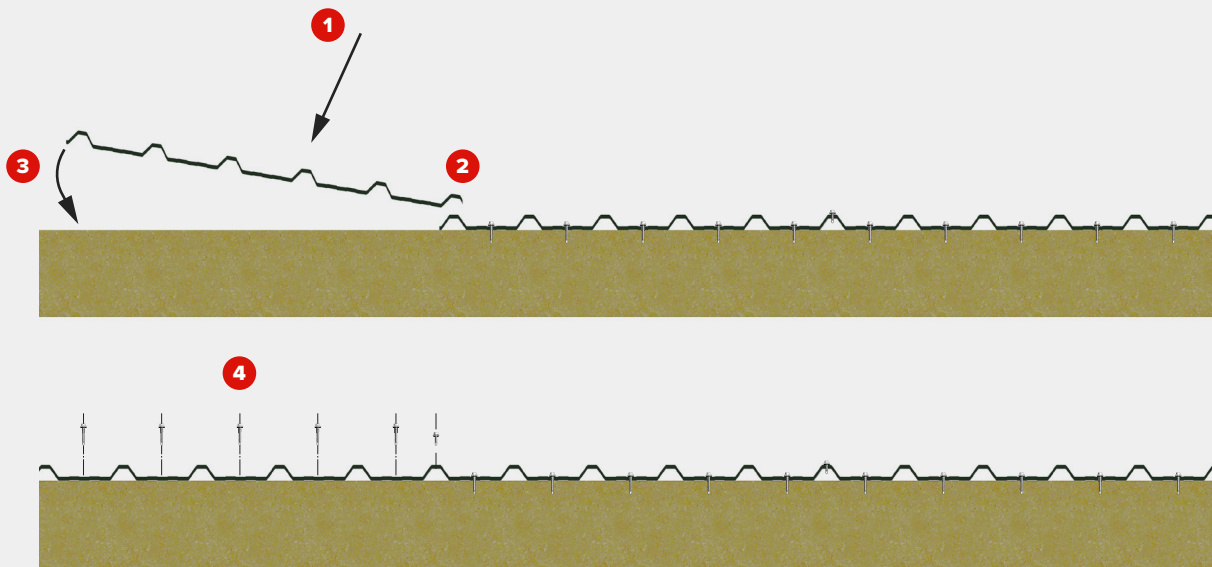

Accessories

Foam fillers

Foam fillers enhance weatherproofing and thermal insulation by sealing gaps, preventing air and water ingress, and reducing heat loss. They also offer sound insulation, dampening external noise, and protect against pests and debris. Additionally, foam fillers provide structural support to sheets, helping to maintain integrity and improve the installation's appearance.



Butyl mastic and sealants

Butyl mastic and sealants are essential for creating watertight and airtight seals in installations. They prevent water, air, and dust from entering joints and seams, improving weather resistance and reducing the risk of leaks. They help enhance insulation by preventing heat loss, contributing to better energy efficiency and durability in various weather conditions.

